

Malden Close  
Cambridge  
CB5 8NU

### Newmarket Road

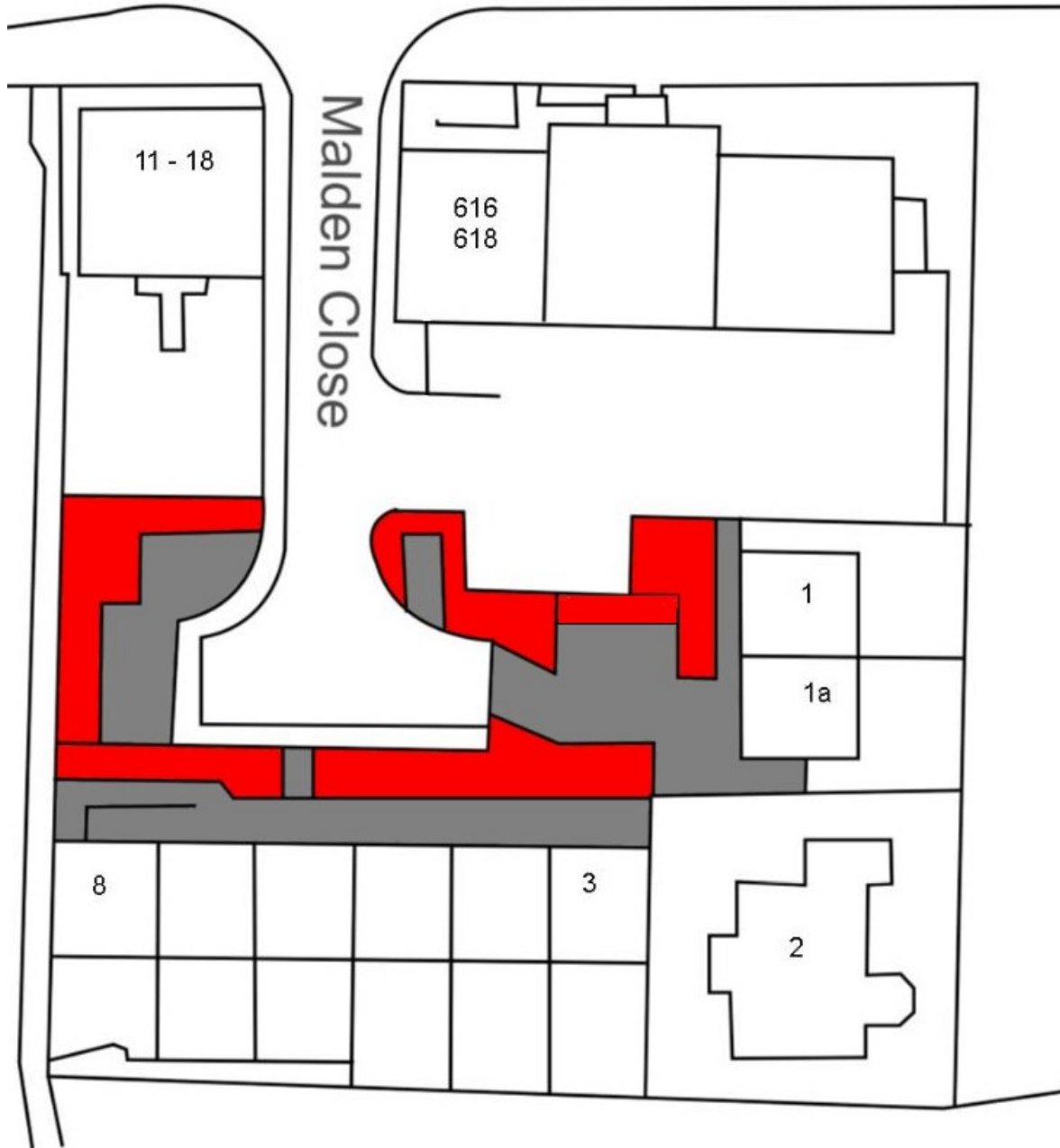

					
Grass	Shrubs	Hard Standing	Hedges	Meadow Grass	Trees

All CHS plans and information about what is included in our contract can be found at  
<https://www.chsgroup.org.uk/my-chs-home/rented-homes/gardening-schedule/>



### **Gardening information**

**1. Grass cutting** – as a guide this service is delivered from March – October time. Yet if the grass is scorched from dry weather grass cutting would not take place until the grass has recovered. If weather is very wet grass cutting would not be successful therefore would be completed at the next visit.

**2. Meadow grass** – this is wildlife friendly grass that is usually planted with long grasses and wildflowers, which provide a source of nectar for insects. Meadow grass is low maintenance and requires two cuts per year in spring and autumn.

**3. Shrub maintenance** – pruning of shrubs is expected to take place three times per year, generally between May and October. Care will be taken not to cut any shrubs that are in flower or are ready to flower. Once flowering is over the shrubs will be cut back.

**4. Hedge maintenance** - Formative pruning is usually carried out in winter or early spring. After this, maintenance trimming is carried out, usually once a year for informal hedges and twice a year for formal hedges. Some formal hedges may need three cuts a year; this would depend on the type of hedge species. PLEASE NOTE: It is recommended not to cut hedges between March and August as this is the main breeding season for **nesting birds**. However, in reality the nesting period may start before this and extend beyond those months. It is an offence (under The Wildlife & Countryside Act 1981) to not disturb nesting birds in the UK.

**5. Tree work** – If trees are located within the garden of your home it is your responsibility to maintain them. If trees are located within communal areas, they are (usually) CHS responsibility to maintain. Tree works are carried out during wintertime and after leaf fall so that the trees are lighter and easier to work on.

**6. Hard landscaped areas** (car parks and communal pathways leading to block entrances) – will be swept at each visit and kept debris and litter free. **Weeds** will be sprayed and removed once they have died down.

**7. Gardening team** – the operatives will carry identity and arrive in sign written vehicles. When they arrive to site, they will undertake an inspection to see what is required (please see points 1, 3 & 4 above). The team will carry out gardening that can be done at the time. There are different teams and schedules for grass cutting and shrub/hedge maintenance therefore not all gardening will be completed during one visit.

It is acceptable for the gardening team to have a refreshment break while onsite.

© Crown copyright [and database rights] [2018] OS [100059699]. Use of this data is subject to [terms and conditions](#)

click here to see the terms and conditions: <https://www.chsgroup.org.uk/garden-plans-copyright/>

<https://www.chsgroup.org.uk/garden-plans-copyright/>